

ACCESS PLAN
SCALE 1:200

Aberdeenshire COUNCIL Infrastructure Services

APPROVED

In terms of the decision dated and application reference:

APP/2021/1264
20/10/2022

SITE PLAN
SCALE 1:200

LANDSCAPING LEGEND

GRASSED AREA -
GRASS SEED MIX TO BE - 30% RYEGRASS, 65% FESCUE AND 5% BENT GRASS. BRITISH SEED HOUSES J123 MIX - SOWING RATE 25-35gm PER SQM, JOHNSONS SEEDS J123 MIX - SOWING RATE 18 - 30gm PER SQM, OR APPROVED EQUIVALENT.

HEDGE PLANTING -
EXISTING HEDGING SOUTH AND EAST BOUNDARIES TO BE RETAINED WHERE POSSIBLE.
WHERE NECESSARY REPLACEMENT HEDGE TO COMPRISE OF DOUBLE ROW OF BECH AND HAWTHORN PLANTS COMPRISING AN EQUAL NUMBER OF EACH SPECIES PLANTED AT 0.5m CTS APART AND BE FULLY PROTECTED BY WIRE MESH RABBIT FENCING.

PROPOSED TREE SPECIES
PICEA SITCHENSIS (SITKA SPRUCE)
BETULA PENDULA (SILVER BIRCH)
PRUNUS AVIUM (WILD CHERRY)
SORBUS ACUCAPARIA (ROWAN)

TREE PLANTING -
TOPSOIL TO BE SPREAD TO A DEPTH OF 250mm.
ANY PERENNIAL AND ANNUAL WEED GROWTH TO BE KILLED WITH AN APPLICATION OF AN APPROVED GLYPHOSATE HERBICIDE.
PRIOR TO PLANTING, ALL NEW TOPSOIL AREAS TO RECEIVE 50-75gm PER SQM OF AN APPROVED SLOW RELEASE FERTILISER IF WEED GROWTH IS CONTROLLED.
TREES TO BE PIT-PLANTED AT A MINIMUM OF 4 METRE CENTRES AND TIED TO A TIMBER STAKE BY TWO RUBBER TIES WITH SPACERS.
THE TREE PIT TO BE 450x450x300mm AND BACKFILLED WITH TOPSOIL CONTAINING 200gm PER HOLE OF SLOW RELEASE FERTILISER.
TREES TO BE PROVIDED WITH PLASTIC SPIRAL GUARDS AS DIRECTED.

TREE MANAGEMENT -
NEW PLANTED AREA TO BE PROTECTED DURING THE BUILDING WORKS AND FOR AN ESTABLISHMENT PERIOD OF 2-3 YEARS FOLLOWING PLANTING WITH AN APPROVED FENCE.
IN ACCORDANCE WITH THE PERCEIVED GROWTH RATES, NEW TREE PLANTING TO BE THINNED AT 5 YEARLY INTERVALS AFTER PLANTING.
AN AREA OF 1m DIAMETER AROUND EACH TREE TO BE KEPT FREE FROM WEED AND GRASS GROWTH USING AN APPROVED HERBICIDE.
STAKES AND TIES TO BE REGULARLY CHECKED AND ADJUSTED AS REQUIRED.
STAKES TO BE REMOVED AFTER 3-5 YEARS.
MANAGEMENT SCHEME TO BE ALL IN ACCORDANCE WITH BS 5837 1991.

PLANTING PROGRAMME -
ALL PROPOSED LANDSCAPING TO BE COMPLETED DURING THE PLANTING SEASON IMMEDIATELY FOLLOWING THE COMMENCEMENT OF THE DEVELOPMENT OR SUCH OTHER DATE AS MAY BE AGREED IN WRITING WITH THE PLANNING AUTHORITY.
ANY PLANTING WHICH, WITHIN A PERIOD OF 5 YEARS FROM THE COMPLETION OF THE DEVELOPMENT IS DYING, BEING SEVERELY DAMAGED OR BECOMING SERIOUSLY DISEASED SHALL BE REPLACED BY PLANTS OF A SIMILAR SIZE AND SPECIES.
ALL TREES TO BE PLANTED AS WHIPS.

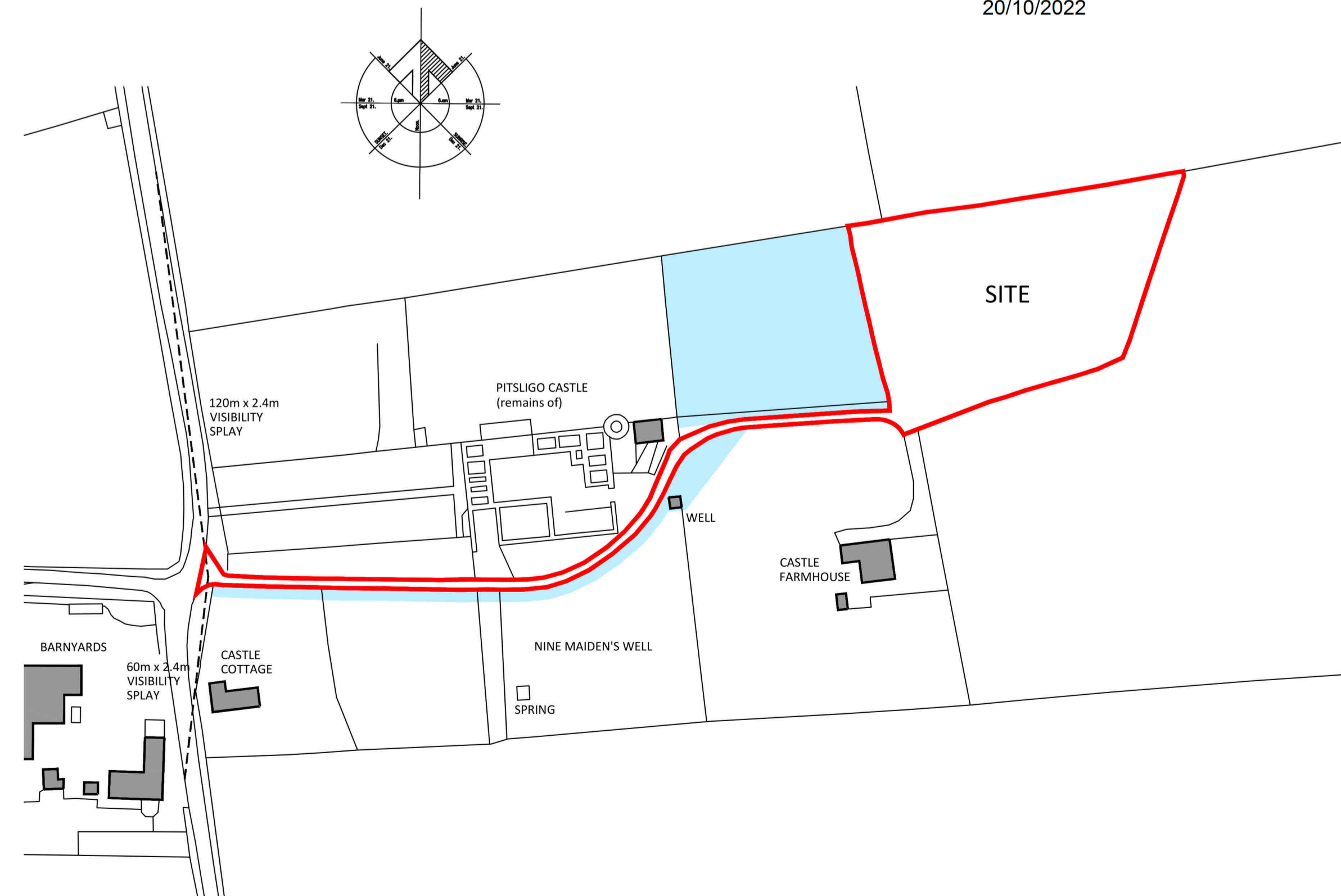

SITE LOCATION PLAN
SCALE 1:1250

THE COPYRIGHT OF THIS DRAWING IS THE PROPERTY OF CALEDONIA HOMES (SCOTLAND) LTD AND MUST NOT BE COPIED OR REPRODUCED WITHOUT WRITTEN CONSENT			
PLEASE CONTACT CALEDONIA HOMES SHOULD YOU REQUIRE ANY ADDITIONAL DETAILS / DIMENSIONS NOT SHOWN ON THIS DRAWING - DO NOT SCALE			
C A	10/03/22 09/02/22 13/02/21	DC DC DC	Client amendments Client amendments Planning amendments
Revision Number	Date	Drawn By	Comments
CALEDONIA HOMES Home Builders by Design			
PROJECT PROPOSED DWELLING AT CASTLE FARM STEADING ROSEHEARTY FRASERBURGH AB43 7NU			
CLIENT Mr & Mrs BUCHAN			
Drawing Title SITE PLANS			
Scale	Date		
AS NOTED	MAY 2021		
Drawn By	Dwg No.		
DC	1641 - 200		
Caledonia Homes, Castle Street, Castle Road Ind Est, Ellon, Aberdeenshire, AB41 9HF Tel: 01358 721661 Fax: 01358 722955 Email: sales@caldoniahomes.co.uk			